

# Palomar Estates

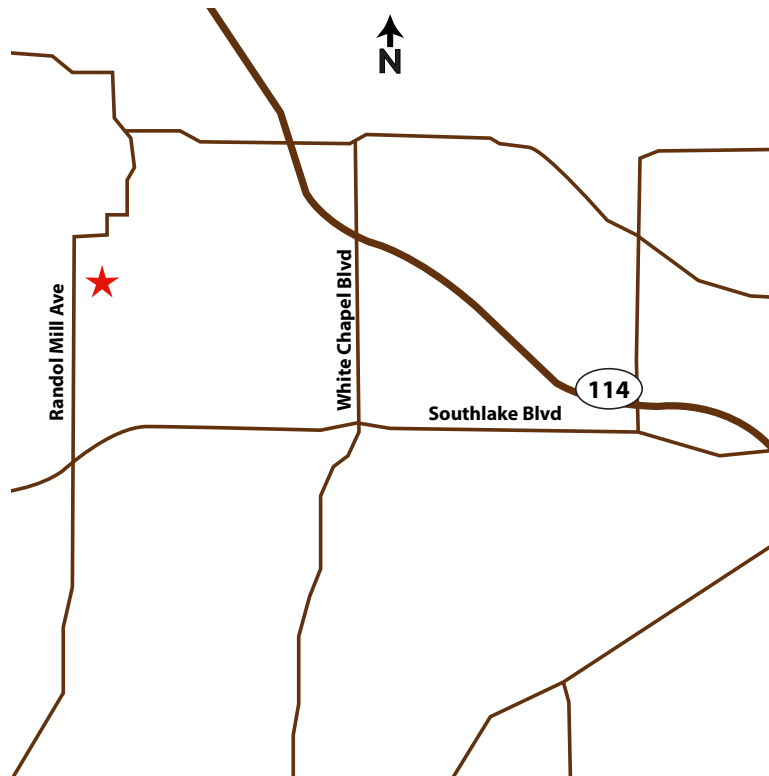

## DIRECTIONS

Take 114 West to the Wall Street/Southlake Blvd Exit.  
Make a Left and proceed to Randoll Mill Avenue.  
Once you reach Randoll Mill Avenue/FM 1938, proceed north  
and Palomar Estates will be north of Gifford Court on your right.

*For more information on this community, contact:*

**Centurion American**  
DEVELOPMENT GROUP

817.391.2500

email: [info@centurionamerican.com](mailto:info@centurionamerican.com)

[www.centurionamerican.com](http://www.centurionamerican.com)